

Electric Towel Rail

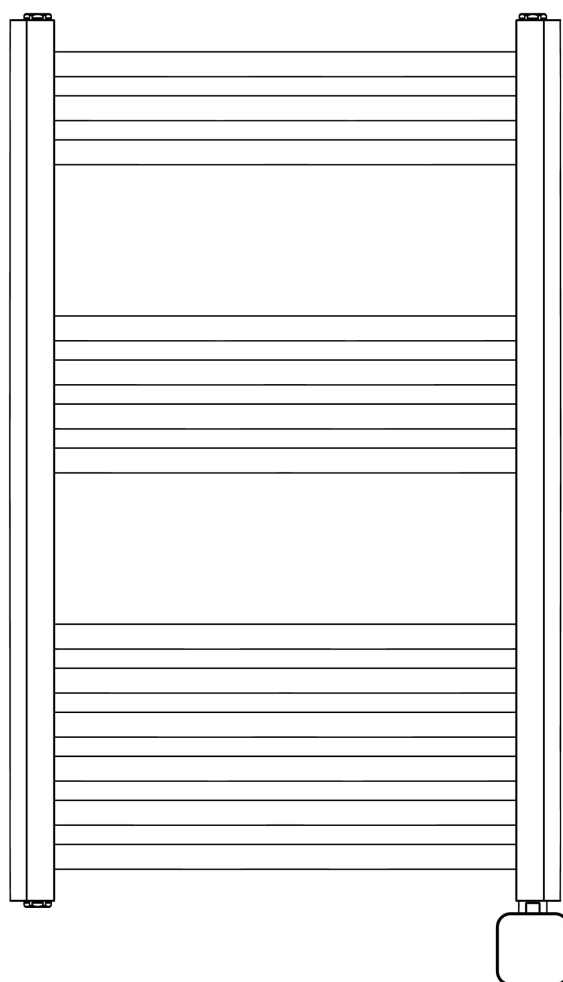

Table of contents

1. Warnings	03
2. Tools Required	04
3. Items in Box	04
4. Installation	05-06
5. Control Panel	07
6. Manual Operation	
Standby Mode	07
Heating Mode	07-08
7. Connecting to Wi-Fi	
Downloading the App	09
Connecting to the App	09
Adding Devices	09-10
8. Using the App	
Home Overview	10
Control Interface	11
Choose Mode	11
Timer Mode	11
9. Device settings	
Program	12-13
Room Temperature Compensation	14
Child Lock	14
Open Window Detection	14
Heat Plus	14
10. Technical Information	15
11. Disposal	15

Please read this instruction carefully before installation and operation.



Warning: This device must be installed by a licensed electrician.

- This Towel Rail is not intended for use by persons (including children) with reduced physical, sensory or mental capabilities, or lack of experience and knowledge, unless they have been given supervision or instruction concerning use of the Towel Rail by a person responsible for their safety.
- Children must not play with the appliance. Cleaning and maintenance must not be carried out by children without supervision.
- In order to avoid a hazard, this appliance must be installed so that the bottom rail is at least 600mm above the floor.
- The towel rail is intended to warm and dry towels only. It becomes hot during operation, PLEASE BE CAREFUL!
- The towel rail must be installed so that switches and other controls cannot be touched by a person in the bath or shower.
- Do not use the towel rail to hold towels or other items that have been in contact with oil, petroleum-based products, or dry-cleaning fluids.
- Use this Towel Rail only with the voltage specified on the rating label.
- Do not immerse the appliance in water or allow liquid to enter any part of it. Indoor use only.
- Do not operate this towel rail if damaged or after the Towel Rail malfunctions or has been dropped or damaged in any manner. Return to a qualified electrical person for examination, electrical service or repair.
- Use this Towel Rail only as described in this manual. Any other use is not recommended by the manufacturer and may cause fire, electrical shock or injury.
- Do not use the appliance in a window or location where it may be exposed to rain or moisture, as this may result in electric shock.

TOOLS REQUIRED

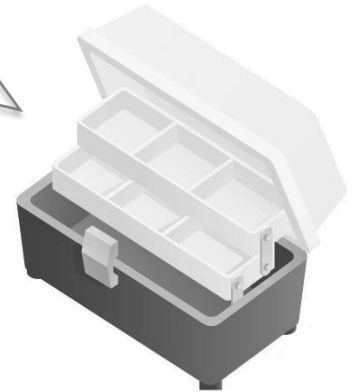
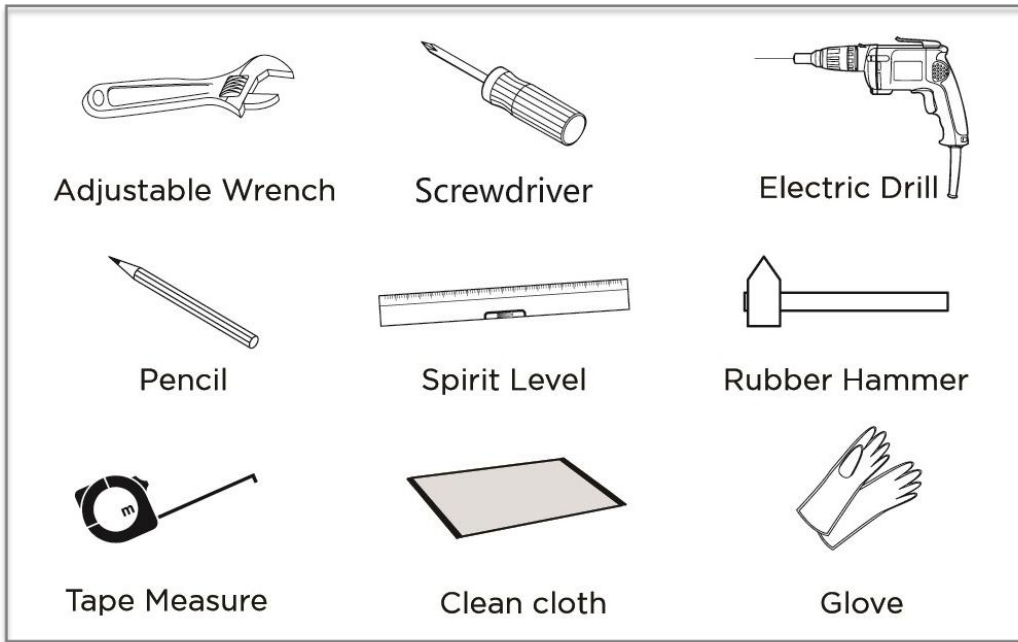

ITEMS IN BOX

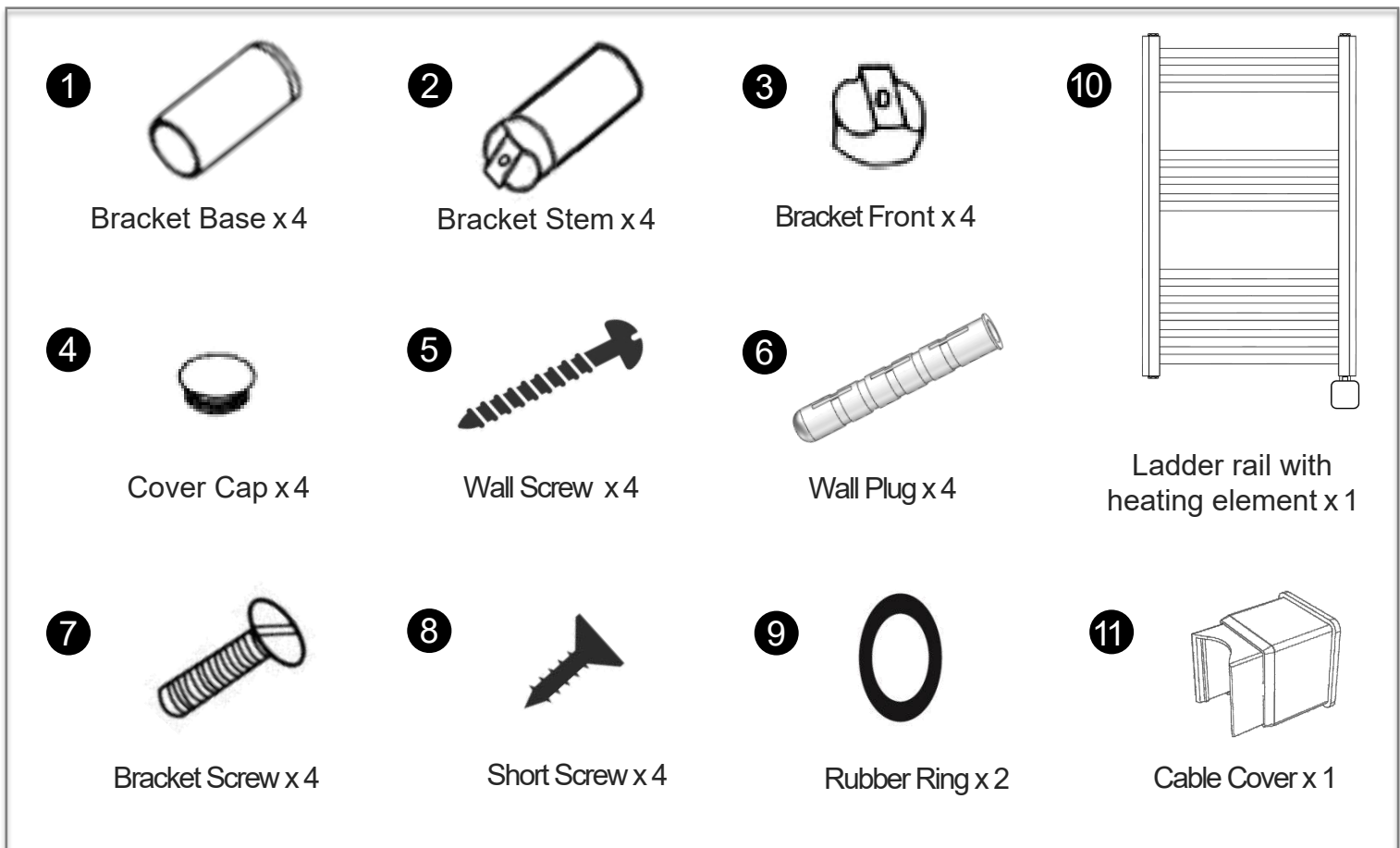

INSTALLATION

STEP 1

Ensure that the wall is capable of supporting the weight of the pre-filled towel rail. For plasterboard walls, we strongly recommend securing the brackets directly into the timber studs.

STEP 2

Position the towel rail in the desired location and check that it is level. Mark the bracket positions with a pencil. Drill holes in the wall and insert the wall plugs. (Accessories Required: 6)

Note: For false or stud walls, suitable alternative fixings can be purchased from your local DIY store.

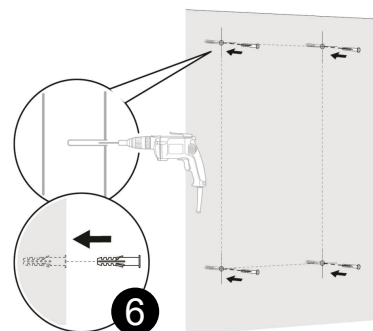

STEP 3

Insert the wall screws through the bracket bases and tighten them securely into the wall. (Accessories Required: 1&5)

Note: Ensure the small screw holes on the bracket bases face outward for tightening the short screws later.

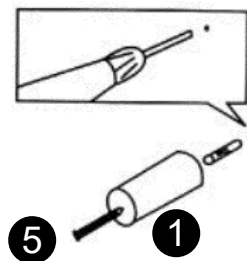

STEP 4

Fit the bracket stems to the towel rail with the bracket fronts and bracket screws. (Accessories Required: 2,3,7)

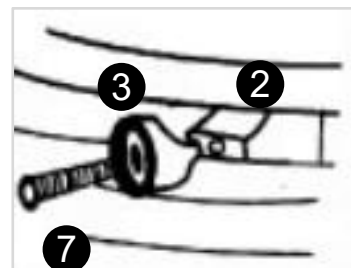

INSTALLATION

STEP 5

Align the bracket stems with the bracket bases, push the towel rail back into position, and tighten the short screws to secure it. (Accessories Required: 8)

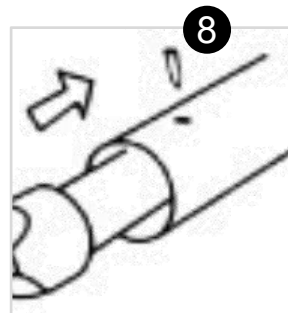

STEP 6

Press the cover caps onto each bracket front until they click into place. (Accessories Required: 4)

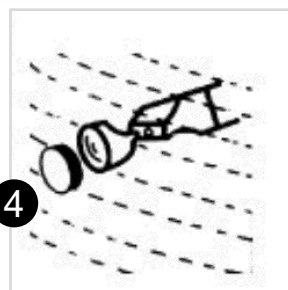

STEP 7

Connect the heating element to the mains power using a BS fused connection unit.

The wires should be connected as follows: **Blue** (Neutral), **Brown** (Live), **Green/Yellow** (Earth).

Installing the Cable Cover



- Slide the cover into the track.
- Lock the cable into the hole.



CONTROL PANEL

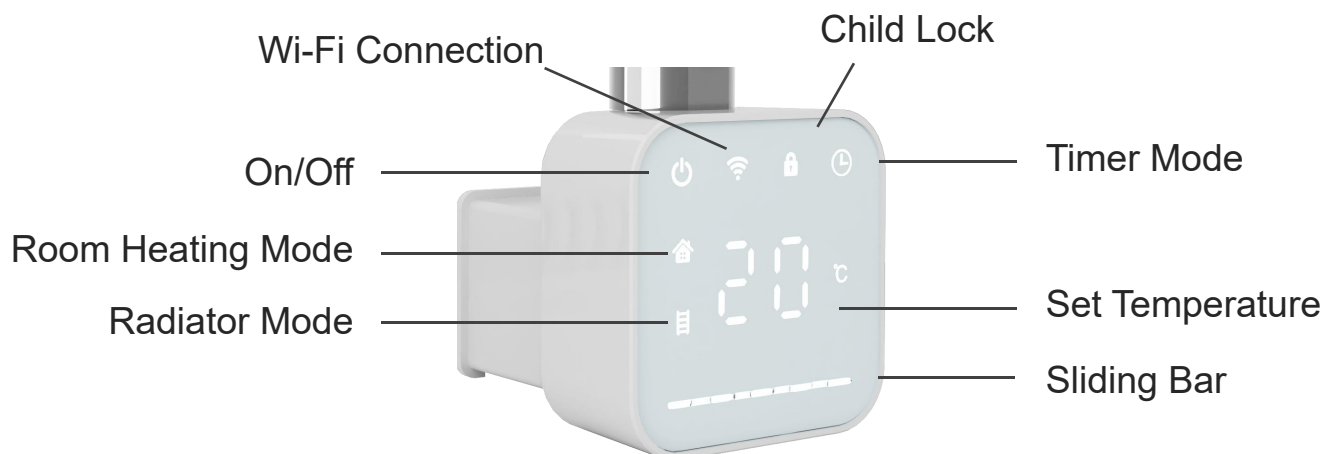

Note: During operation, the screen will light up for one minute and then turn off. Pressing any button during this time will turn the screen back on, allowing any operation to be performed during this period.

MANUAL OPERATION

1.1 Standby Mode

Once the controller is powered on, the unit will go into standby mode. You can press the button  to switch between ON/OFF.

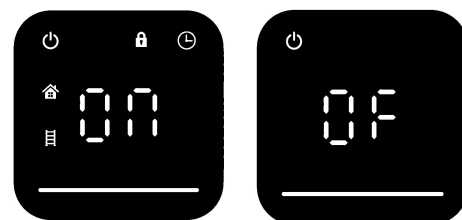



1.2 Heating Mode

Press  to switch the controller on. Press the corresponding icons to switch between modes. There are six modes: Room heating mode, Radiator mode, Timer mode, LST mode, Anti-freeze mode, Child Lock.

1.2.1 Room Heating Mode

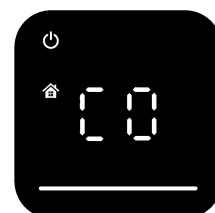

In this mode, the element controls the room temperature and heats to a constant set temperature. The external thermostat measures the ambient temperature and instructs the element to heat or stop heating according to the temperature set.

- Press the  button to enter the room heating mode. In this mode, the set temperature and "CO" will alternately flash. The icon  will flash while heating and remain steady once the target temperature is reached.
- The set temperature can be adjusted by sliding the bar located at the bottom of the screen. The temperature can be set within a range of 15-30°C in steps of 1°C.





1.2.2 Radiator Mode

In this mode, the element controls the radiator's internal temperature and heats to a constant set temperature. The internal thermostat measures the temperature of the heating fluid and instructs the element to heat or stop heating according to the temperature set.

- Press the  button to enter the radiator mode. In this mode, the icon  will appear and flash while heating, then remain steady once the target temperature is reached.
- The set temperature can be adjusted by sliding the bar located at the bottom of the screen. The temperature can be set within a range of 30-70°C in steps of 5°C.

1.2.3 Timer Mode



The element will stay working at the setting hours at maximum performance which is heating the fluid under 70°C. After heating at the setting hours, it will return to standby mode.

- Press the  button in any mode to enter Timer mode. In this mode, "2H" will be displayed on the screen and the icon  will flash while heating and remain steady once the target temperature is reached.
- The timer duration is set to 2 hours and cannot be adjusted.



1.2.4 LST(Low surface temperature) Mode

In this mode, the element controls the radiator's internal temperature and heats to a constant 43°C and cannot be adjusted.

- In the powered-on state, press and hold both the  and  buttons for about 3 seconds to enter this mode. The icon  will flash while heating and remain steady once the target temperature is reached.



1.2.5 Anti-freeze Mode

If the radiator's internal temperature drops below 7°C, the heating system will automatically activate, heating the liquid inside the radiator to 15°C before switching off again. (This function is set to default and does not appear in the interface.)

In this mode, it will prevent the liquid in the radiator from freezing and can also maintain a low room temperature.

1.2.6 Child Lock

Use this function to prevent any change in the thermostat setting.

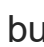
Press and hold the  button for 3 seconds to lock the display. The  icon will appear and all buttons including the  button will be locked. Repeat the same procedure or cut off the power to unlock it.

Remark: When the internal temperature exceeds the set temperature, the icon corresponding to the mode on the screen will blink twice.

CONNECTING TO WI-FI



1.1 Downloading the App

Download the APP onto your smart phone. You can find the app by scanning the QR code below or searching “Smart Life” in the Google Play or Apple app store. Install and follow the app’s instructions to create an account.



NOTE - The Smart Life app is a constantly evolving third party system. This guide was correct at time of printing but may differ slightly from future versions. The app is designed to work on Android or iOS but older software versions may affect app presentation and performance.

1.2 Connecting to the App

To put the device in pairing mode, press  to enter power OFF mode and hold down  button for 2 seconds, coming with a sound “DI”, it is in pairing stage and WIFI icon starts flashing, follow the below operation you can operate the paring job.

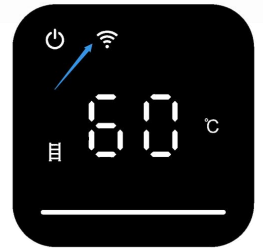

1.3 Adding devices

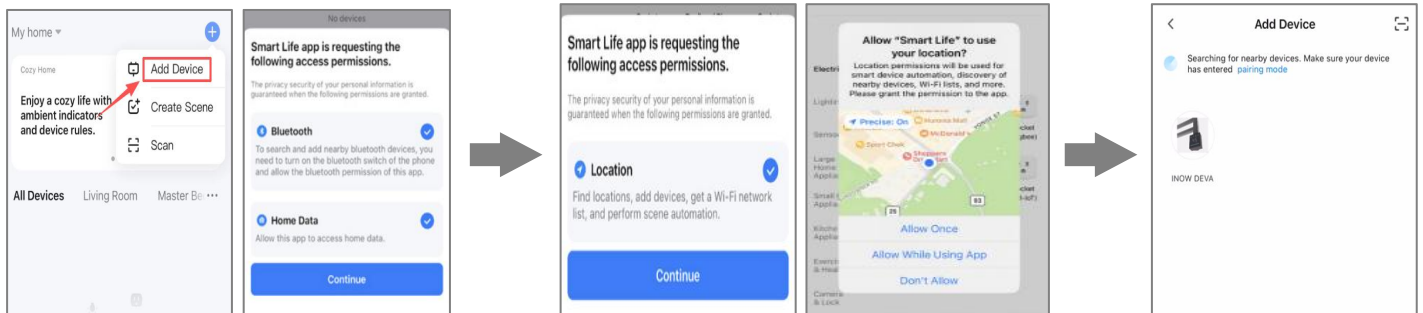

1. Click “+” and “Add Device”. Follow on-screen Bluetooth prompts.

2. Before adding the device, please allow the Location to access.

3. It will search automatically. Tap the device icon to add.

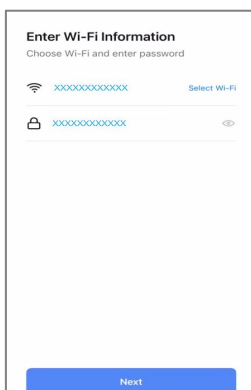

4. Choose your WiFi network and enter the password. Press “Next”.

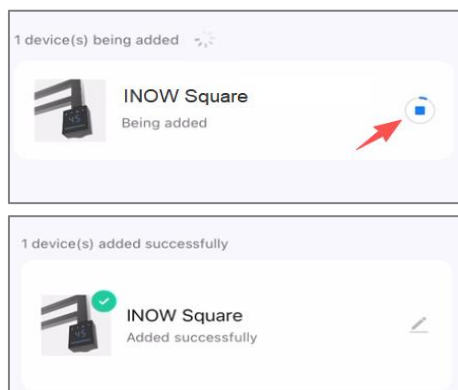

5. The device will begin connecting. Device will display on the APP after successfully added.

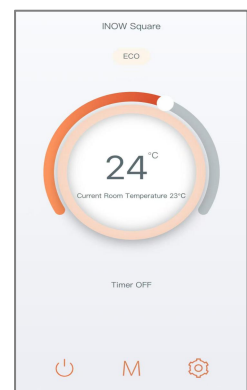

Trouble shooting

If the element does not connect on the first attempt:

- Make sure both the element and your smart device are in range of your router.
- Make sure you complete the connection process in 2 minutes. If the APP cannot connect, you must begin the process again.
- Ensure your router has a strong internet connection.
- Ensure WiFi and Bluetooth are enabled on your smart device.
- Make sure the app has registered successfully.
- Make sure your smart device is connected to the same WiFi network as that to which you are attempting to connect the element.
- Ensure you are connected to a 2.4G WiFi band. See instructions within the app if you are currently connected to a 5G band.
- Check any local restrictions on your WiFi. WiFi networks in public places such as hotels and airports may require extra identification steps.

If the thermostat sensor becomes disconnected, "Er" will be displayed on the screen.

USING THE APP

1.1 Home Overview

You can use the Smart Life app to control multiple devices. All devices are displayed on the home screen with their status.

Possible statuses:

- Online – Device will respond to app commands.
- Offline – Device is turned off at wall or power switch. It cannot be controlled by the app.

1.2 Control Interface

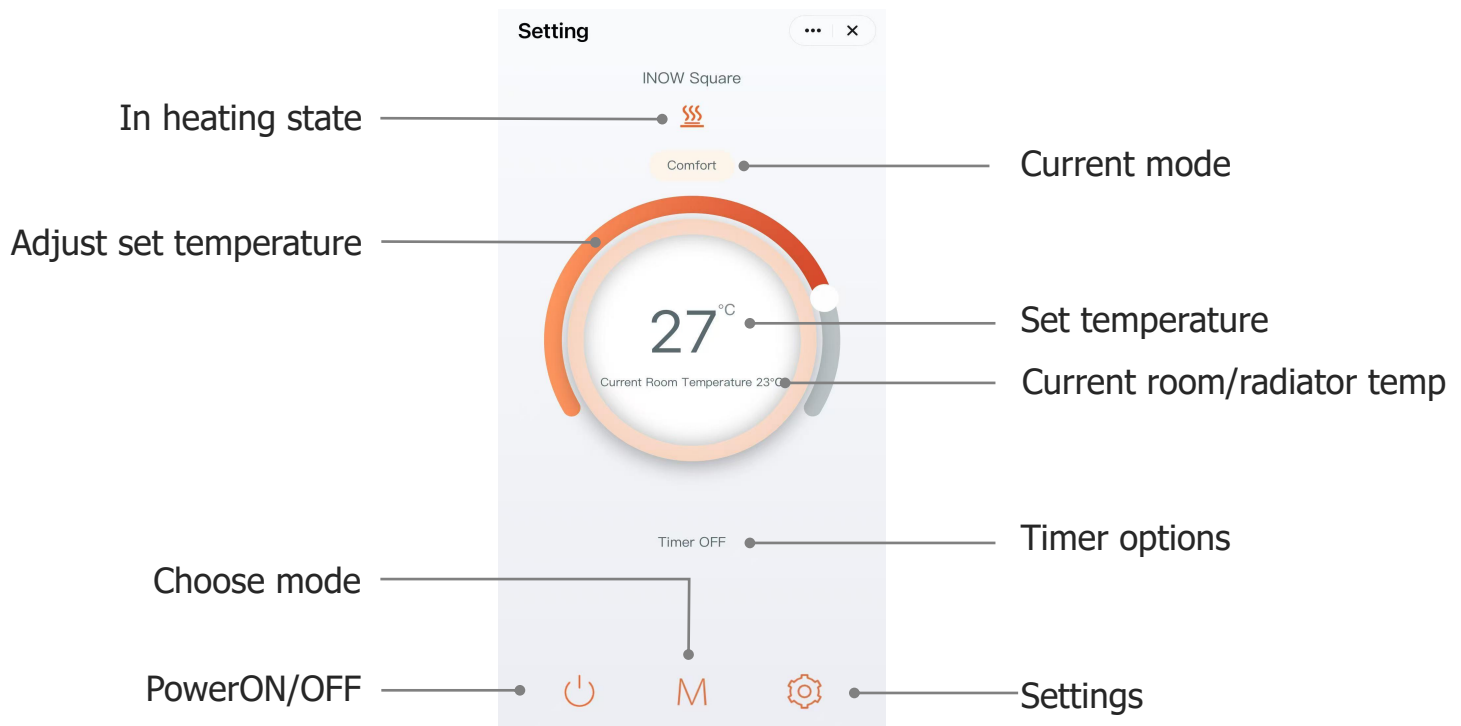

1.3 Choose Mode

Tap the mode button on the interface to choose mode. The four options correspond to the four modes on the control panel. Comfort, Eco, Radiator and LST modes.

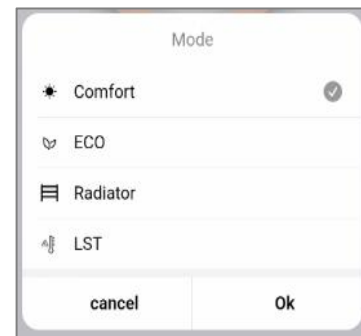

1.3.1 Comfort mode & Eco Mode

In comfort and Eco mode, simply use the sliding dial to adjust the set room temperature.

1.3.2 Radiator Mode

In radiator mode, simply use the sliding dial to adjust the set radiator internal temperature.

1.3.3 LST Mode

The device will operate at 43°C, and the temperature is non-adjustable.

1.4 Timer Mode

Timer options include 2 hours and OFF.

You can temporarily activate MAX working temperature by tapping the timer icon on the APP interface, the device will work at maximum power for 2 hours in radiator mode. After the set working hours are completed, it will return to standby mode.

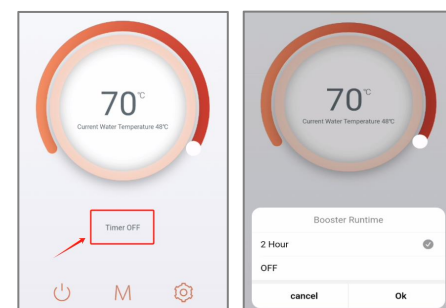

DEVICE SETTINGS

Tap the settings icon to view and adjust the device's settings. This menu allows you to configure several settings not available through the control dial.

1.1 Program

1.1.1 Auto Program

Tap the 'Auto' icon located in the top left corner of the program chart to activate the automatic preset program. The device will run in radiator mode by default program.



You can reset the program from the default automatic setting by clicking on the starting and ending hours on the axis, room temperature, radiator temperature and LST control options are available.

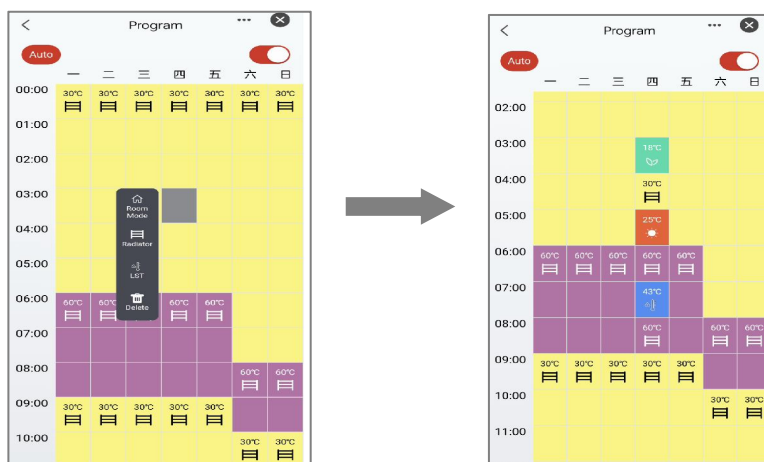

Default data list as below:

Period		Icon	Time	Temperature
Work day (Monday-Friday)	1	☰	6:00	60°C
	2	☰	9:00	30°C
	3	☰	17:00	60°C
	4	☰	22:00	30°C
Weekend (Saturday-Sunday)	1	☰	8:00	60°C
	2	☰	10:00	30°C
	3	☰	17:00	60°C
	4	☰	22:00	30°C

1.1.2 Set the program manually

To set a preferred program, tap the  icon located in the top right corner of the program chart. You can create a program from a blank schedule by clicking on the starting and ending hour on the axis, room temperature, radiator temperature and LST control options are available.

Note: When the time period on the axis is shown in grey, the device is in standby mode.

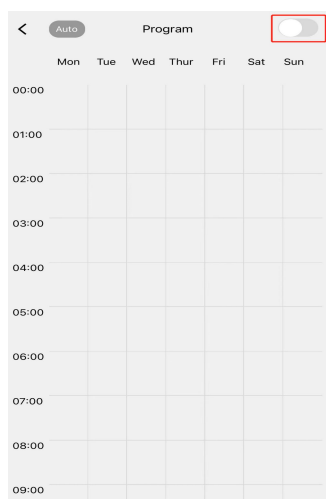

Tap the icon located in the top right corner to switch the program

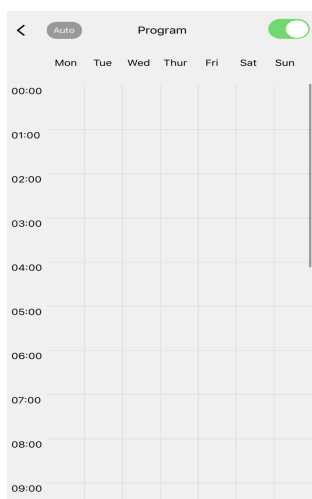

When there is no program input, the area will be displayed in grey color



The device is in standby mode

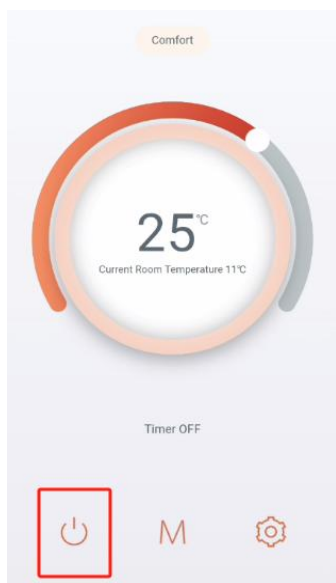

Switch on again

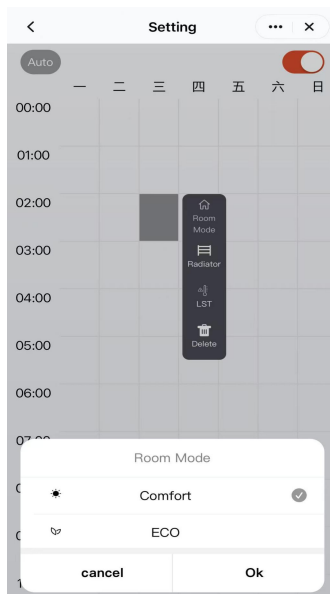

Click the hours on the axis and choose the mode



The selected program is displayed on the chart

1.2 Room Temperature Compensation

The room temperature compensation setting allows users to adjust for any discrepancy between the average room temperature and the temperature sensed by the thermostat.

You can adjust the room temperature compensation in steps of 1°C, from -10°C to 10°C. The default temperature compensation is 0°C.

For instance, if the temperature in the room is 18°C, but the device is sensing 16°C, a compensation factor of +2°C will offset the difference.

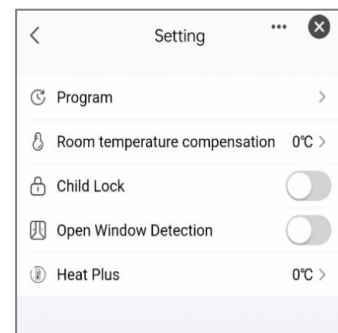

1.3 Child Lock

Use the toggle switch to lock or unlock the element's display.  displays on the screen when the device is locked.

1.4 Open Window Detection

Use the toggle switch to activate the open window detection function.

When the device detects a sudden drop in temperature (3°C or more within 5 mins), it will switch to the anti-freeze temperature (fixed at 7°C) for 30 mins to prevent energy wastage caused by heat escaping through the window. After the designated time period, it will revert back to the previous mode. If the temperature drops by 3°C within 5 mins again, the device will switch back to the anti-freeze temperature and cycle through the process again.

1.5 Heat Plus

Heat plus is a function that lets you adjust the maximum internal temperature of your radiator or heated towel rail, the default cut off temperature is set to 70°C, this can be increased by 5°C to 75°C.

The Heat Plus function can be used for radiators or heated towel rails that have poor circulation where premature cutoff may be an issue.

TECHNICAL INFORMATION

Voltage	230V AC / 50Hz
Wattage	800x500mm:400W / 1200x500mm:700W
Mode	Room Temperature/Radiator/Anti-freezie//Timer/Child Lock/LST
Frost protection	7°C
Temperature setting	Room Temperature: 7°C -30°C Internal Fluid Temperature: 30°C -70°C
IP rating	IPX4
Timer mode	Boost 2 hours
Appliance class	Class I
Thread size	G ½ "
Application	This element is not suitable for dry heating. It must be submerged in liquid (either in a liquid-filled electric-only installation, or as part of a dual-fuel installation).

DISPOSAL



In accordance with WEEE Directive 2012/19/EU, the icon with the crossed-out waste bin on electrical or electronic equipment stipulates that this equipment must not be disposed of with household waste at the end of its life. You will find collection points for free return of waste electrical and electronic equipment in your vicinity. The addresses can be obtained from your local authority.

The separate collection of waste electrical and electronic equipment enables the re-use, recycling and other forms of recovery of waste equipment, and prevents any negative effects for the environment or human health.

Electrorad U.K. Ltd
5-7 Bramley Business Park,
Railsfield Rise, Leeds
LS13 3SA
www.electrorad.co.uk
E: sales@electrorad.co.uk T: 0113 2746799